

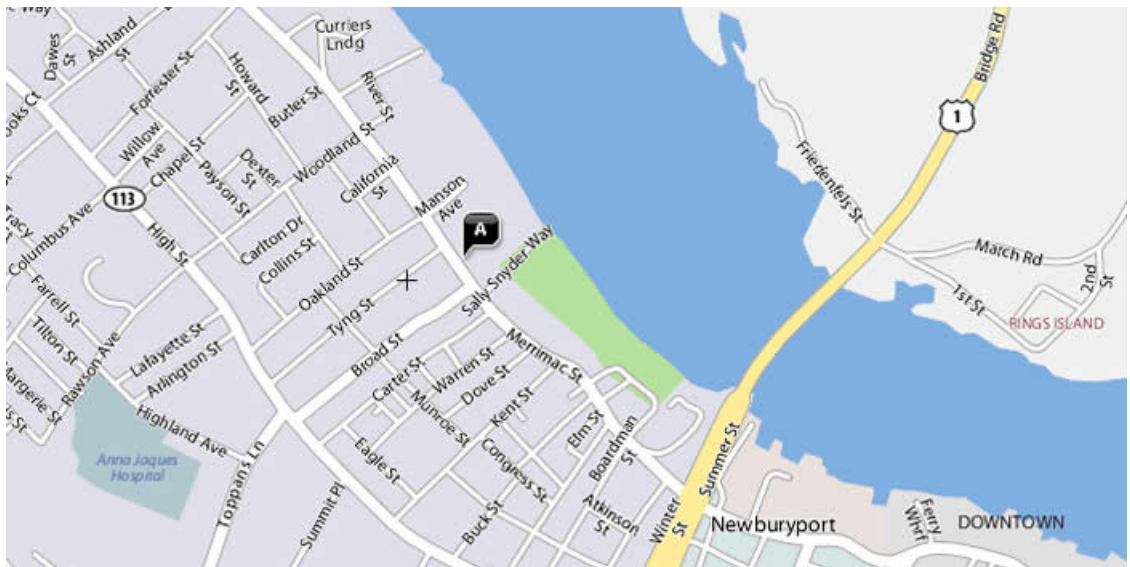

## Towle Office Building

260 Merrimac Street, Newburyport, MA 01950



87430 SF Professional Office Building  
Up To 694 and 9,825 SF Available

### Tenants

Healthcare Complete

Riverside Cafe and Diner Inc.

Mass General Brigham Medical Group - Pentucket

DARLING CONSULTING GROUP

DORE & WHITTIER, INC.

For more information call

1- 212- 279- 6100

THE FIRST REPUBLIC CORP.

OF AMERICA

New York, NY 10001



**Towle Office Building**  
260 Merrimac Street, Newburyport, MA 01950

**Merrimac Street**

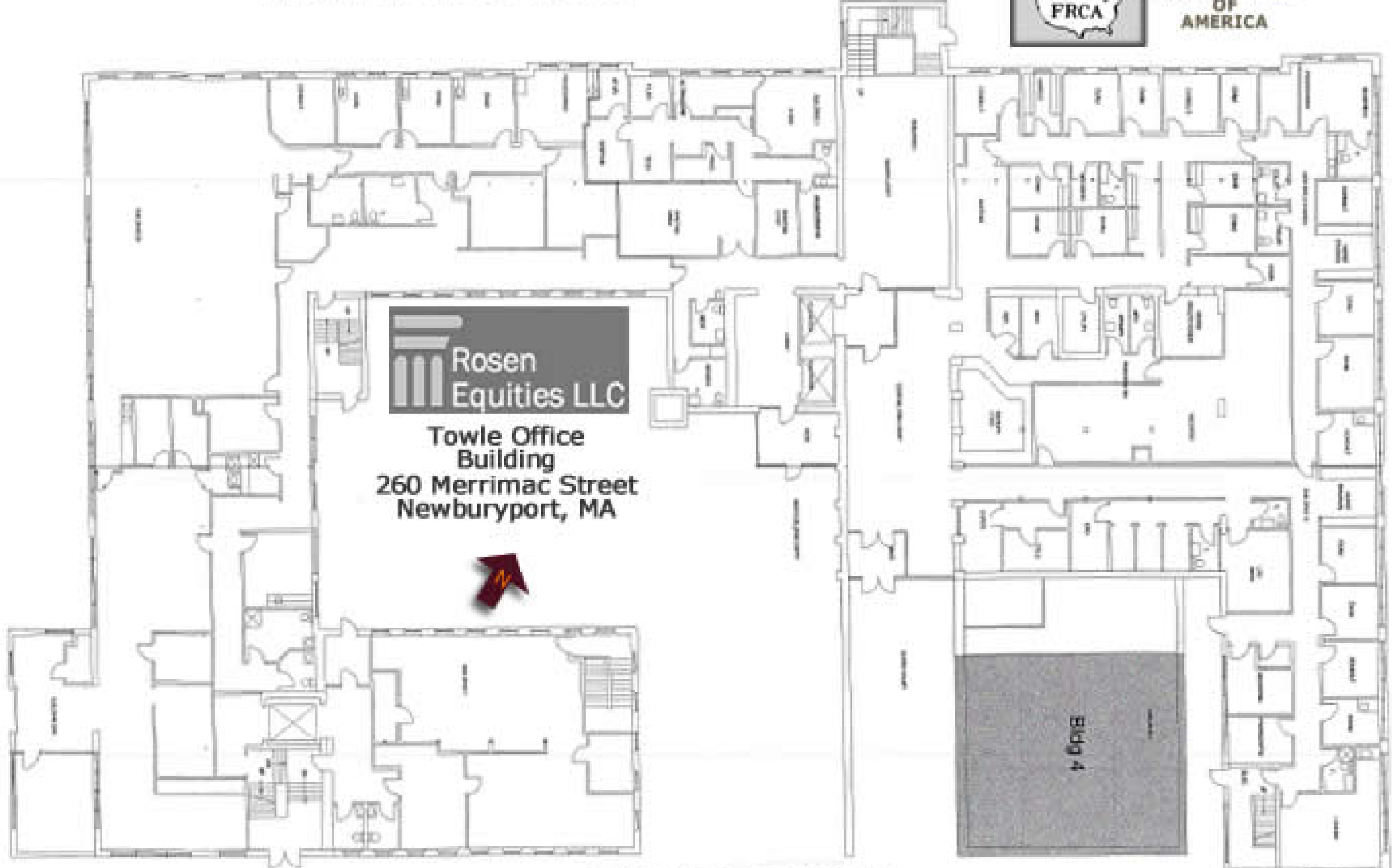

**First Floor Plan**  
**26,793.8 SF**

Demographics	
(15 Mile Radius)	
Population	313,604
Households	123,862
Average Household Income	\$98,081
Median Age	44.1

For more information call  
1- 212- 279- 6100  
THE FIRST REPUBLIC CORP.  
OF AMERICA

New York, NY 10001