

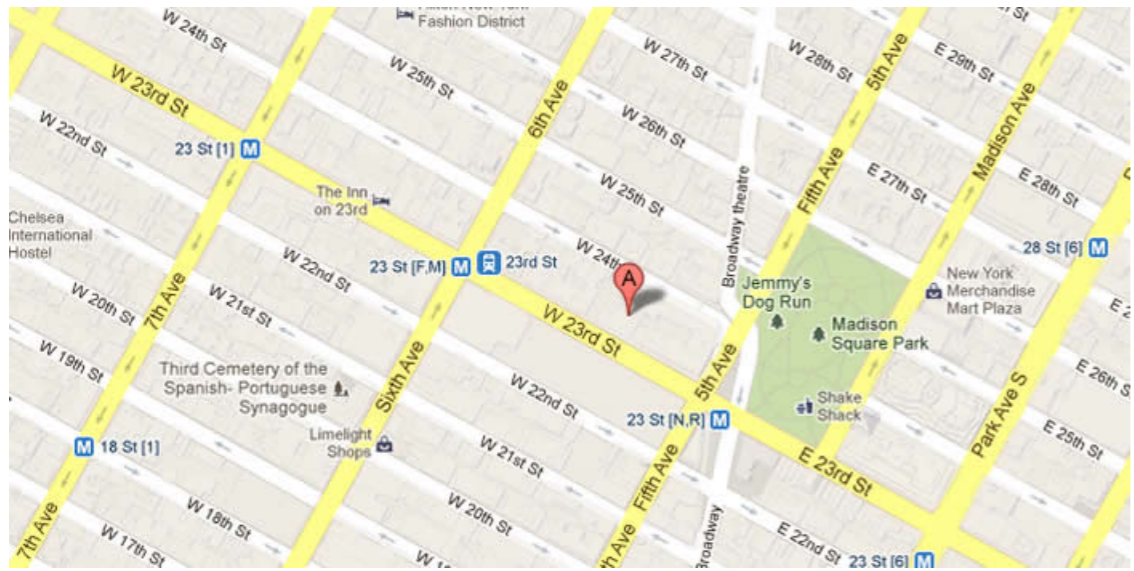

27 WEST 23RD STREET, New York, NY 10010



158730 SF

Up To 25,167 SF Available

Steps from Madison Square Park and Fifth Avenue

this 6 story office building has a brand new lobby and brand new elevators it also has 100 feet of frontage on 23rd street, freight access on 24th street and is conveniently located near a variety of mass transit lines

Located in landmark district Built: 1880

Tenants

Addison Maraj

Daniel Kobin

The Edrington Group USA, LLC

Kathryn Ashcraft

Betterment Holdings, Inc.

For more information call

1- 212- 564- 6662

OLMSTEAD PROPERTIES

575 Eighth Avenue, Suite 2400

New York, NY 10018

info@olmsteadinc.com

27 WEST 23RD STREET, New York, NY 10010

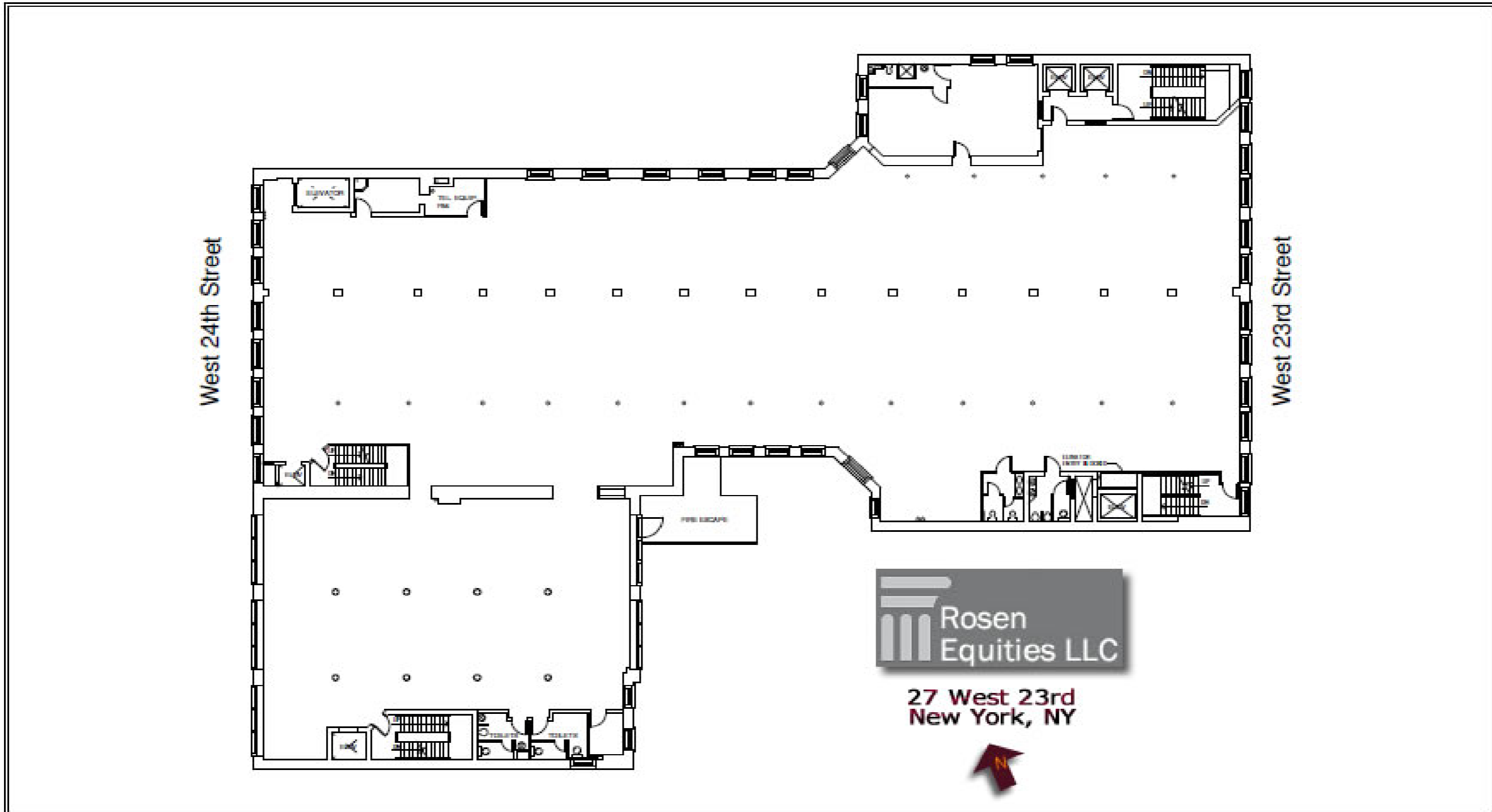

Leasing and Managing Agent



575 Eighth Avenue, Suite 2400
New York, NY 10018
(212) 564-6662
Fax: (212) 564-6667
www.olmsteadinc.com

Typical Floor Plan

All areas and dimensions
are approximate. Field
verification is necessary.
Date Printed: 1/30/2014

For more information call
1-212-564-6662
OLMSTEAD PROPERTIES
575 Eighth Avenue, Suite 2400
New York, NY 10018
info@olmsteadinc.com