

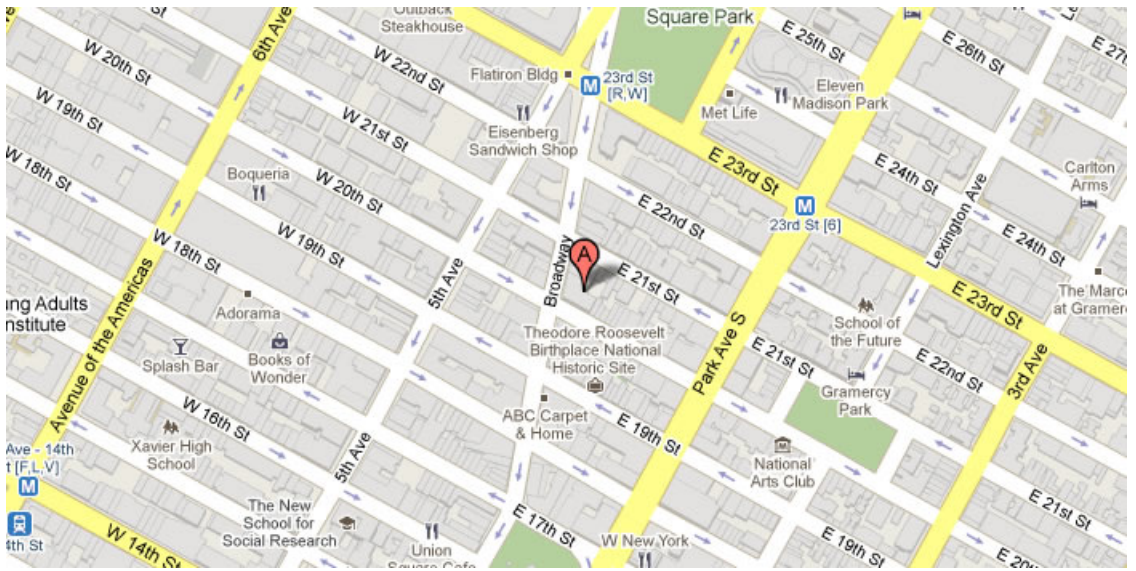

902 BROADWAY, New York, NY 10010



391576 SF

Up to 106,106 SF Available

Office building with modern lobby, private A/C  
upgraded elevators, 24/7 access, full floor identity  
and wood floors

Built: 1913 Architect: Robert T. Lyons

Tenants

For more information call

1- 212- 249- 1550

KOEPEL ROSEN

40 East 69th Street

New York, NY 10021

[mkoepfel@koeppelrosen.com](mailto:mkoepfel@koeppelrosen.com)

902 BROADWAY, New York, NY 10010

## 902 Broadway



Typical Floor Plan

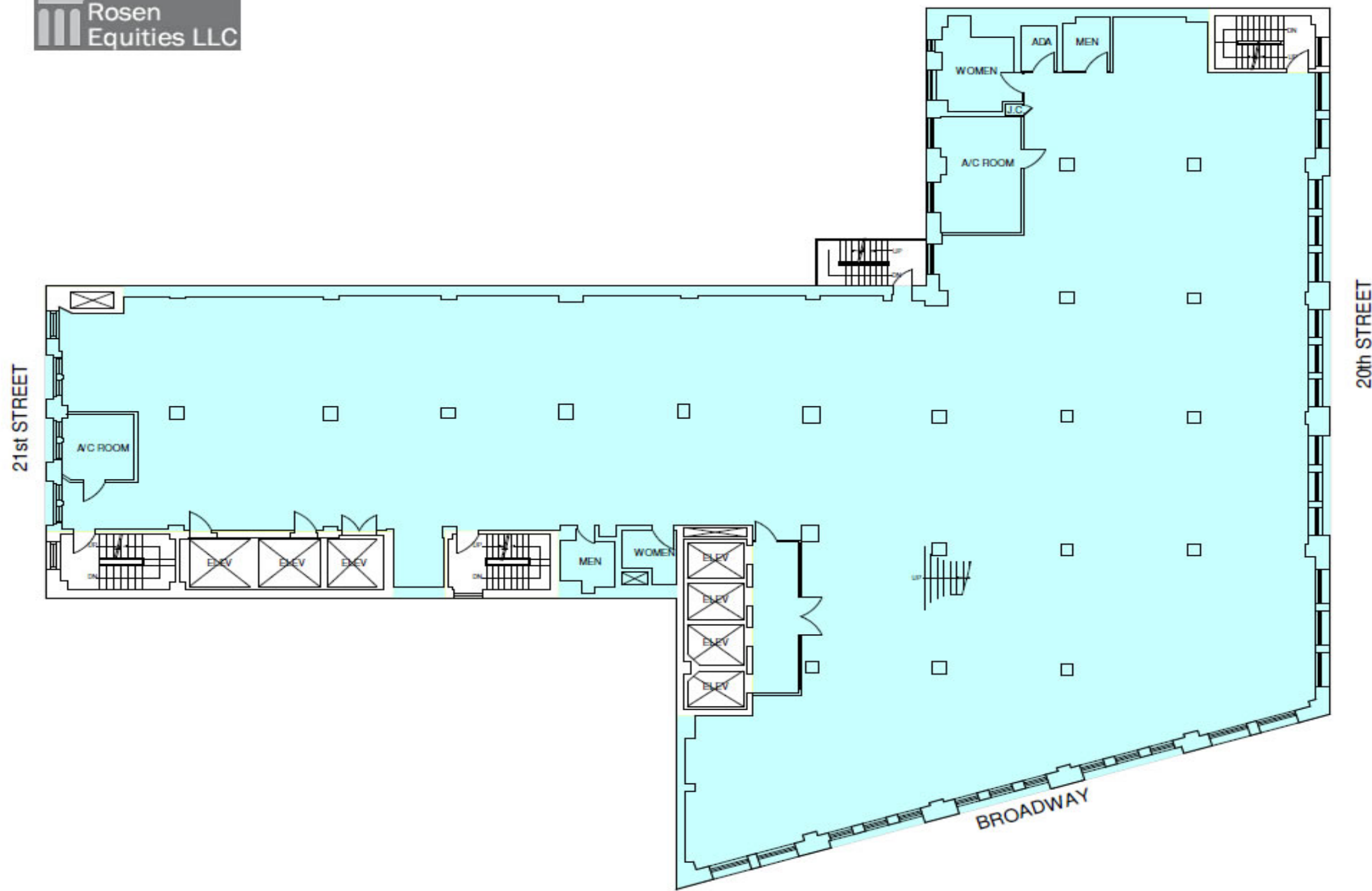

Note: All dimensions and conditions are approximate and for information only

 Koeppel Rosen LLC

40 East 69th Street  
New York, NY 10021  
212-249-1550  
www.koeppelrosen.com

Scale: NTS  
Date: February 18, 2016



 LINK  
SYSTEMS

For more information call  
1-212-249-1550  
KOEPEL ROSEN  
40 East 69th Street  
New York, NY 10021  
mkoeppel@koeppelrosen.com